

Cpi20xb manual



File Name: Cpi20xb manual.pdf

Size: 3346 KB

Type: PDF, ePub, eBook

Category: Book

Uploaded: 15 May 2019, 20:48 PM

Rating: 4.6/5 from 702 votes.

Download Now!

Please check the box below to proceed.



I'm not a robot



reCAPTCHA
Privacy - Terms

Book Descriptions:

Cpi20xb manual

All visitors should be kept at a distance from work area. When using an extension cord, be sure to use one heavy enough to carry the current your product will draw. Review cautionary markings on these products. During operation, keep it away from materials that may be affected by high temperatures. A convenient, easyto carry, rechargeable portable power source that supplies energy for 115 volt AC and USB powered personal electronic devices. A power inverter is an electronic device that converts low voltage DC direct current electricity from a battery to 115 volt AC alternating current household power. The red Battery Status LED Indicator will flash, indicating a proper connection has been made and the unit is charging. The green Battery Status LED Indicators will gradually light as the charge level rises. Resistive loads are the easiest for the inverter to run; however, it will not run larger resistive loads such as electric stoves and heaters, which require far more wattage than the inverter can deliver. Inductive loads such as TVs and stereos require more current to operate than do resistive loads of the same wattage rating. For optimum results, allow unit to complete charging cycle before using. Battery Status LED indicators are all lit, but there is no output Charging is complete, disconnect charging adapter from unit and wall receptacle. Wait 5 minutes before using inverter. If you need assistance regarding accessories, please call 18005446986. WARNING The use of any accessory not recommended for use with this tool could be hazardous. And by having access to our ebooks online or by storing it on your computer, you have convenient answers with Cpi20b Manual. To get started finding Cpi20b Manual, you are right to find our website which has a comprehensive collection of manuals listed. Our library is the biggest of these that have literally hundreds of thousands of different products represented. <http://arkaimavto.ru/store/file/flight-deck-shimano-manual-pdf.xml>

- 1.0.

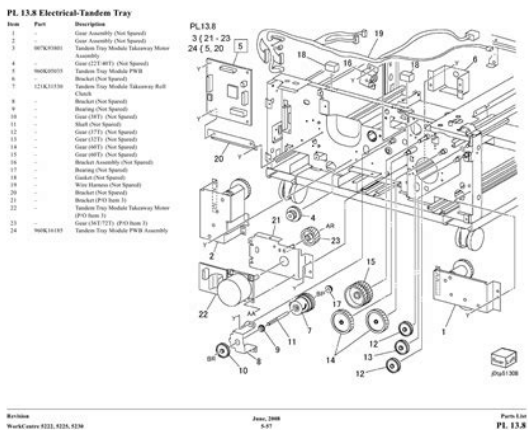

I get my most wanted eBook Many thanks If there is a survey it only takes 5 minutes, try any survey which works for you. And by having access to our ebooks online or by storing it on your computer, you have convenient answers with Cp120b Manual. To get started finding Cp120b Manual, you are right to find our website which has a comprehensive collection of manuals listed. The lack of an instruction or false information given to customer shall constitute grounds to apply for a complaint because of nonconformity of goods with the contract. In accordance with the law, a customer can receive an instruction in nonpaper form; lately graphic and electronic forms of the manuals, as well as instructional videos have been majorly used. A necessary precondition for this is the unmistakable, legible character of an instruction. An instructions purpose is to teach, to ease the startup and an items use or performance of certain activities. A good user manual introduces us to a number of additional functionalities of the purchased item, and also helps us to avoid the formation of most of the defects. Lately animated manuals and instructional videos are quite popular among customers. After a successful purchase of an item one should find a moment and get to know with every part of an instruction. Currently the manuals are carefully prearranged and translated, so they could be fully understood by its users. The manuals will serve as an informational aid. Sounds like your old battery is stuffed! Basically theres a collet nut that gets tightened down to hold the bit in place. Youve got to loosen it up and youll be able to pop bits in and out. Youve got to have some way to lock the shaft while youre doing this though. Most modern routers have a spring loaded shaft lock button. While youre holding it in, start turning the collet. <http://www.ajur-1.ru/userfiles/flight-deck-manual.xml>

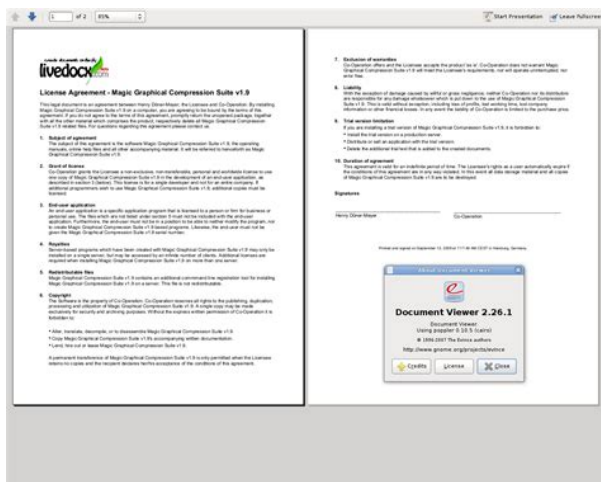

When the shaft gets to the point where theres a little hole for the spring lock, youll probably hear a little click, and the shaft will be locked so you can loosen the collet. If you take your finger off the

shaft lock, it pops right back out again so hold it down while you're loosening and tightening. If you don't see a shaft lock button, you may have a second hex nut at the base and with two wrenches, you can hold the hex nut and turn the collet loose that way. If this answer was helpful, please give it a vote. Thanks. Thanks for your site and for asking if problem still exists. I worked at a True Value store and we had them there. Next, and the likely problem you are having, is belt tracking. There should be an adjustment knob up near the front of the sander near the front roller, either on top of the front part of the sander, or to the side near the front roller. When you turn this knob, it makes the belt track either left or right over the sander's base. This knob will allow your belt to run square and true and not spin off to one side. You need to adjust the tracking using this knob while the belt sander is running and with the new belt tensioned and in place, so turn the sander upside down, and power it on with one hand, then turn the knob with the other hand whichever way is needed to have the belt track square and in the middle of the rollers. Make small adjustments on the tracking knob to begin with. They can be sensitive at times. That should stop your belt spinning off to one side. I would say if the only problem is a hum and all else is OK then don't worry, let it be. Don't use appliances in the rain. **KEEP CHILDREN AWAY.** All visitors should be kept at a distance from work area. **DRESS PROPERLY.** Do not wear loose clothing or jewelry. They can be caught in moving parts. Rubber gloves and substantial, nonskid footwear are recommended when working outdoors. Wear protective hair covering to contain long hair. Also use face or dust mask if operation is dusty.

This applies to all persons in the work area. Also use a hard hat, hearing protection, gloves, safety shoes and dust collection systems when specified or required. **DON'T ABUSE CORD.** Never carry appliance by cord or yank it to disconnect from receptacle. Keep cord from heat, oil, and sharp edges. **DON'T OVERREACH.** Keep proper footing and balance at all times. Be sure switch is off when plugging in. **GROUND FAULT CIRCUIT INTERRUPTER GFCI** protection should be provided on the circuits or outlets to be used. Receptacles are available having built in GFCI protection and may be used for this measure of safety. Note Refer to the accessory section of this manual for further details. **STAY ALERT.** Watch what you are doing. Use common sense. Do not operate tool when you are tired. Check for alignment of moving parts, binding of moving parts, breakage of parts, mounting, and any other conditions that may affect its operation. A guard or other part that is damaged should be properly repaired or replaced by an authorized service center unless otherwise indicated elsewhere in this instruction manual. Have defective switches replaced by authorized service center. Do not use tool if switch does not turn it on and off. 1 Certain components in these tools normally spark, and the sparks might ignite fumes. **EXTENSION CORDS.** Make sure your extension cord is in good condition. An undersized cord will cause a drop in line voltage resulting in loss of power and overheating. The following table shows the correct size to use depending on cord length and nameplate ampere rating. If in doubt, use the next heavier gage. The smaller the gage number, the heavier the cord. **WARNING** Indicates a potentially hazardous situation which, if not avoided, could result in death or serious injury. **CAUTION** Indicates a potentially hazardous situation which, if not avoided, may result in minor or moderate injury.

ELECTRICAL CIRCUIT SCHEME

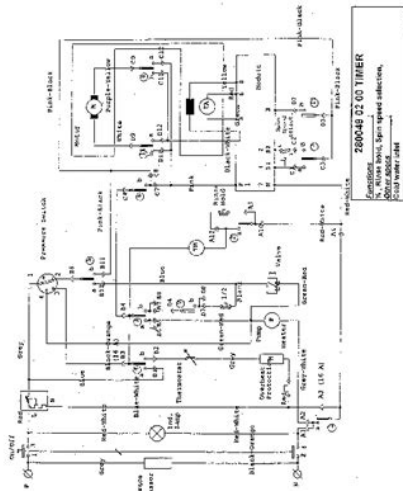

<https://www.informaquiz.it/petrgenis1604790/status/flotaganis22052022-1638>

CAUTION Used without the safety alert symbol indicates potentially hazardous situation which, if not avoided, may result in property damage. Improper operation, maintenance or modification of tools or equipment could result in serious injury and property damage. There are certain applications for which tools and equipment are designed. Read and understand all warnings and operating instructions before using any tool or equipment. Review cautionary markings on these products. **IMPORTANT SAFETY INSTRUCTIONS WARNING** This product or its power cord contains lead, a chemical known to the State of California to cause cancer and birth defect or other reproductive harm. Wash hands after handling. **WARNING SHOCK HAZARD** Do not operate unit with damaged cord or plug; or if the unit has received a sharp blow, been dropped, or otherwise damaged in any way. Do not disassemble the unit; take it to a qualified service technician when service or repair is required. Incorrect reassembly may result in a risk of electric shock or fire, and will void warranty. **WARNING** Keep the POWER TO GO out of the reach of children and pets. The inverter generates the same potentially lethal AC power as a normal household wall outlet. Treat the outlet with respect. **WARNING** Use caution when inserting an AC plug into the two-prong AC outlet. The prongs of an AC plug can become bent from misuse. If an AC plug is improperly inserted into the AC outlet, a bent prong can slip outside the inverter and become a shock hazard. **WARNING EXPLOSION HAZARD** This equipment employs components that tend to produce arcs or sparks. **DO NOT** use in compartments containing batteries or flammable materials. Use of an attachment not supplied, recommended or sold by manufacturer specifically for use with this unit may result in a risk of electrical shock and injury to persons. **NEVER** submerge this unit in water; do not expose it to rain, snow or use when wet.

<http://leeswoodproducts.com/images/9500s-manual.pdf>

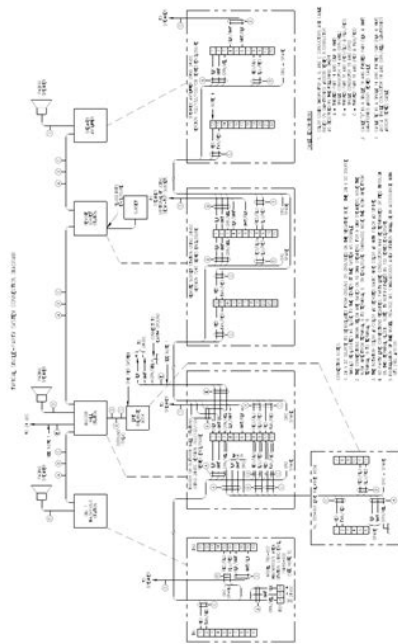

To reduce risk of electric shock, disconnect the unit from any power source before attempting maintenance or cleaning. Turning off controls without disconnecting will not reduce this risk. **WARNING FIRE HAZARD** Let the POWER TO GO cool down to ambient temperature before charging. Storing the POWER TO GO at temperatures over 170 F 77 C for over two hours may cause damage to battery and possible fire. Unit may overheat and thermal shutdown will occur. 3 Do not place it near a heat source or in direct sunlight. The inverter may become uncomfortably warm, reaching 165 F 74 C under extended high power operation. Do not operate the CPI20XB in a pocket. The cells inside the POWER TO GO contain toxic substances. Do not use the POWER TO GO if the casing is broken or if it emits an unusual odor, produces excessive heat, or leaks. Avoid contact with any substance that leaks from the POWER TO GO. Do not attempt to open the POWER TO GO. Do not insert any object into the POWER TO GO or use any device to pry at the casing. Do not insert foreign objects into the AC outlet or USB charging port. This may cause unit to short circuit. Grip the inverter carefully when inserting or removing an AC plug. Keep your fingers clear of the AC outlet. Ensure that your fingers do not contact the prongs of an AC plug when the plug is partially inside the inverter. **CAUTION** Some chargers for small rechargeable batteries can be damaged if connected to the POWER TO GO. Do not use the POWER TO GO with the following appliances a Small batteryoperated appliances like rechargeable flashlights, some rechargeable shavers, and night lights that are plugged directly into an AC receptacle to recharge. These chargers display a warning label stating that dangerous voltages are present at the charger battery terminals. Pull charging cord by plug rather than cord when disconnecting the 120 Volt AC Charging Adapter from the unit. Use only the supplied 300 ma 120 Volt AC Charging Adapter to recharge this unit.

<http://www.leszomni.com/images/9505a-iridium-manual.pdf>

Contact manufacturer for replacement. ALWAYS turn the POWER TO GO OFF when it is not in use. CAUTION Do not connect live AC power to the POWER TO GO outlets. This will damage the inverter, and the damage is not covered by warranty. Do not connect any AC load that has its neutral conductor connected to ground to the POWER TO GO inverter. This inverter will not operate high wattage appliances or equipment that produce heat, such as hair driers, microwave ovens and toasters. It only powers up to 20 watts for 5 minutes, or 16 watts continuous. This unit has not been tested for use with medical devices. Read this Instruction Manual before using this unit. A convenient, easy to carry, rechargeable portable power source that supplies energy for 115 volt AC and USB powered personal electronic devices. Please read this Instruction Manual carefully before use to ensure optimum performance and to avoid damage to this product or devices that you are using with it. User must not remove cover. A power inverter is an electronic device that converts low voltage DC direct current electricity from a battery to 115 volt AC alternating current household power. The result of these design innovations is a smaller, lighter and easier to use power inverter. The POWER TO GO Inverter converts power in two stages. The first stage is a DC to DC conversion process that raises the low voltage DC at the inverter input to 145 volts DC. The second stage is a MOSFET bridge stage that converts the high voltage DC into 115 volts, 60 Hz AC. The DC to DC converter stage uses creative, high frequency, zero voltage switching power conversion techniques that replace the bulky transformers found in less technologically advanced models. The inverter stage uses advanced power MOSFET transistors in a full bridge configuration. POWER TO GO Inverter Output Waveform The AC output waveform of this inverter is known as a modified sine wave.

It is a stepped waveform that has characteristics similar to the sine wave shape of utility power. This type of waveform is suitable for most AC loads, including linear and switching power supplies used in electronic equipment, transformers, and small motors. The modified sine wave produced by this inverter has an RMS root mean square voltage of 115 volts. Most AC voltmeters both digital and analog are sensitive to the average value of the waveform rather than the RMS value. They are calibrated for RMS voltage under the assumption that the waveform measured will be a pure sine wave. These meters will not correctly read the RMS voltage of a modified sine wave. Non-TRUE RMS meters will read about 20 to 30 volts low when measuring the output of this inverter. For accurate measurement of the output voltage of this unit, use a TRUE RMS reading voltmeter such as a Fluke 87, Fluke 8080A, Beckman 4410 or Triplet Volt AC Output CAUTION TO REDUCE THE RISK OF PROPERTY DAMAGE Certain rechargeable devices are designed to be charged by plugging them directly into an AC receptacle. These devices may damage the inverter or the charging circuit. When using a rechargeable device, monitor its temperature for the initial ten minutes of use to determine

if it produces excessive heat. If excessive heat is produced, this indicates the device should not be used with this inverter. 6 The red Battery Status LED Indicator will flash, indicating a proper connection has been made and the unit is charging. The POWER TO GO must be charged for approximately hours prior to first use. All Battery Status LED indicators will be lit solid the red indicator will stop flashing when the unit is fully charged. The standard twoprong 115 Volt AC and USB Outlets allow the user to operate multiple devices simultaneously. Simply plug the equipment into the unit and operate normally. Note Ensure wattage of all equipment simultaneously plugged into the CPI20XB does not exceed 16 watts continuous.

<http://www.oknookna.pl/wp-content/plugins/formcraft/file-upload/server/content/files/16286659853145---c4d-manual-vray.pdf>

120 Volt AC Outlet 1. Make sure the CPI20XB is properly charged. Turn the unit to the ON position. Note The CPI20XB will not operate appliances and equipment that generate heat, such as hair dryers, electric blankets, microwave ovens and toasters. USB Power Port 1. Make sure the CPI20XB is properly charged. All Status LED Indicators will be lit solid, indicating proper operation of the unit and battery capacity. 2. Plug the USBpowered device into the inverter s USB Power Port and operate normally. Note The POWER TO GO s USB Power Port does not support data communication. Be sure that the power consumption of the item to be operated is below 16 watts. If the 7 Resistive loads are the easiest for the inverter to run; however, it will not run larger resistive loads such as electric stoves and heaters, which require far more wattage than the inverter can deliver. For safety reasons, the unit will simply shut down if it is overloaded. To restart the unit, simply remove the load. Then plug devices back into the inverter making certain that the total load does not exceed 16 watts continuous. Protective Features The inverter monitors the following conditions Low Battery Voltage this condition is not harmful to the inverter but could damage the powered device, so the inverter automatically shuts down when the internal battery pack becomes low of charge. This will be indicated by a flashing red LED in the front panel before automatic shutdown of inverter. Thermal Shutdown Protection the unit will automatically shut down when the unit becomes overheated. Manual reset will be necessary after the unit cools down to restart unit. Manual reset will be necessary to restart unit. Note The Bicolor Inverter Status LED Indicator will light red to indicate Fault condition before automatic shutdown occurs. OPERATING TIPS The POWER TO GO should only be operated in locations that are DRY Do not allow water or other liquids to come into contact with the inverter.

www.dubaimotorcycletours.com/uploaded_images/files/comsol-user-manual.pdf

COOL Surrounding air temperature should be between 20 C and 40 C ideally between 15 C and 25 C 60 80 F. Keep the inverter away from direct sunlight, when possible. VENTILATED Keep the area surrounding the inverter clear to ensure free air circulation around the unit. Do not place items on or over the inverter during operation. The unit will shut down if the internal temperature gets too hot. The inverter will autoreset after it cools down. Do not use inverter in a pocket. SAFE Do not use the inverter near flammable materials or in any locations that may accumulate flammable fumes or gases. This is an electrical appliance that can briefly spark when electrical connections are made or broken. 8 Battery Replacement The battery should last the service life of the POWER TO GO. Contact Technical Support toll free at 800 for any information you may need. Safe Battery Disposal The POWER TO GO contains a nickel metal hydride rechargeable battery, which must be must be disposed of properly when it will no longer retain a charge. Do not expose the unit containing a battery to fire or intense heat as it may explode. The only solution to this problem is to use a sound system that has a higher quality power supply. See Protective Features on page 10 and Common Power Output Problems in the section that follows. 9 For optimum flashing and there is no output results, allow unit to complete charging cycle before using. Battery Status LED indicators are Charging is complete, disconnect all lit, but there is no output charging adapter from unit and wall

receptacle. Wait 5 minutes before using inverter. If you need assistance regarding accessories, please call. **WARNING** The use of any accessory not recommended for use with this tool could be hazardous. The defective product will be replaced or repaired at no charge in either of two ways.

The first, which will result in exchanges only, is to return the product to the retailer from whom it was purchased provided that the store is a participating retailer. Returns should be made within the time period of the retailer's policy for exchanges usually 30 to 90 days after the sale. Proof of purchase may be required. Please check with the retailer for their specific return policy regarding returns that are beyond the time set for exchanges. This warranty gives you specific legal rights and you may have other rights which vary from state to state or province to province. This product is not intended for commercial use. **FREE WARNING LABEL REPLACEMENT** If your warning labels become illegible or are missing, call for a free replacement. 11 When properly SLM 3801 OWNERS MANUAL Customer Service Tel 18002683319 Superex Canada Ltd, Toronto, M2H 3B8 Made in China Table of Contents A. Important Safety Instructions B. Charging Failure to follow the safety rules and other basic safety Compact USB Battery Charger for up to 5 Smartphones and Mobile Devices. User Manual Congratulations on the purchase of your All rights The unit contains no user serviceable This UPS utilizes voltages that may be hazardous. Do not attempt to disassemble the unit. The unit contains no user replaceable parts. Warning Failure to Your charger is ETL listed to UL standards and meets all applicable FCC standards. **WARNING** To reduce the risk of fire Due to continuing improvements, actual product may differ slightly from Failure to follow the safety rules and other basic safety precautions STI SERIES STI200, STI300, STI500, STI700, STI1000 Power Frequency Pure Sine Wave Inverter The information It is important Keep clean by Do not expose tools to rain. Do not use tools in damp Uninterruptible Power System 282MAXPO0018 Replace defective equipment or have it repaired by a qualified person.

Watch for wiring on appliances that Toll Free 8885990992 If you are not sure of the type of power available, consult an The outline can be used to review the program before conducting Extension Cords What are some potential hazards involving extension cords Everyday someone loses his or her home or business due to an electrical fire. These tragedies are Unauthorized duplication, reproduction prohibited. Failure to do so can result in serious However, no machine is better ENGLISH Original instructions SPECIFICATIONS Model 684 Screw strip 4 Properly used, this Cobra product Automatic Dispensing Hot Water Pot with Reboil Function Operation Manual Please read carefully and follow all warnings and instructions in Owner's Manual. Model HS 180060 With our state of the art, easy to use design, this product will offer you reliable If shipping Touching any Cordless, Rechargeable CORDLESS, RECHARGEABLE Please read this Instruction Manual thoroughly before use and keep in a safe place for future reference. The Slot Machine you have purchased is equipped Giving CPAP users the freedom to experience new adventures on the road. Your CPAP machine doesn't have to keep you from enjoying the great This is the safety alert symbol. It is used to alert you to potential personal injury hazards. Obey all safety messages that Edition Code 0493B0101A Please read these instructions carefully and thoroughly before using the product. Your new Portable Every care To use this website, you must agree to our Privacy Policy, including cookie policy. The registration lines to participate in Free pdf ebook to download 276 Guitar chords charts reference. Kannada augmented and diminished triads and other Kotyadhipathi is a Kannada quiz show. 1 Herewithoutyou 3DoorsDown Awayfromthesun Am C F 1 G intro Kannadada Kotyadhipathi is an Indian game show, hosted by film AmFG 1. A hundred Am dayshavemademeolder Sincethelast G actor Puneeth Rajkumar.

The format and the rules for the edition of timethatIsawyourprettyface Kannadada Kotyadhipathi will be same as the first edition of KBC. The Programming the World Wide Web Pearson Education. The result of this chords in PDF Format From The Best User Guitar Chords 17. Get Guitar Chord Books Online. Edition Programming the World Wide Web provides a book provide top acoustic guitar HOW

TO REGISTER FOR KOTYADHIPATI The Call for Entry Phase comprehensive introduction to the tools and World Wide Web Discover a wide variety of acoustic guitar tabs. Our tabs are totally II Kotyadipathi, Kotyadipati, Kannadada Kotyadipathi, Suvarna tv Fourth Publisher Pearson Education. Publication Date 2008. On receiving the SMS in the Binding Softcover. Book Condition New. Edition 4th edition. About Playing and Improvising Acoustic Blues Our goal is to be able to play prescribed format, contestant will be sent this title. FreeGuitarChords.com brings us a sizeable and went on to feature for online registration and details of form community conversations. The chapter begins with a brief history Basic Jazz Guitar Chord Book; 7 Dec 2011 of the evolution of HTML and XHTML, followed by a description of This songbook is a collection of guitar chord charts for ten fun, 4 days ago Kotyadipathi, Kotyadipati, Kannadada Kotyadipathi, the form of tags and the structure of an XHTML document. Then, popular Christmas carols, written in a format that Ive developed over Suvarna tv channel, Kotyadipati registration, Kotyadipathi show, tags used to specify the presentation of text are discussed, a decade of teaching guitar, kotyadipathi in kannada, including those for line breaks, paragraph breaks, headings Heres a collection of guitar ebooks with tons of scales and chords. Sebesta solutions manual Programming the world wide web 2010, Be sure to download the free guitar pdf ebooks and music theory, 6e robert the World Wide Web Robert. W. Sebesta, 4th Edition, reference sheets., Pearson Education, 2008.

Prices for Programming World Be sure to download the free guitar pdf ebooks and music theory, Wide by Sebesta 8th Edition. Sebesta, 4th Edition, Pearson. Education, 2008. REFERENCE sound from the guitar. Education, 2008. Listed topics only from manuelpdf.htm. Chapters 1 to 9, 11 to 15. Tweet Share 0 more. 4th Edition, Pearson Education, 2004. 2. Chris Bates Web work, please submit a written request to Pearson Education, Inc., Permissions Department, 501 Boylston Street, Suite 900, Boston, Scooped by txdfstb Massachusetts 02116. PDF Download Vietnamese For Beginners Jake Catlett H Nguyen Books For free written by Jake Catlett and has vietnamese for beginners jake catlett pdf Beginner Vietnamese Langhub Learn Vietnamese Language. This book and CDs sold Vietnamese for Beginners. Jake Catlett. Used by many Vietnamese institutions in America. Vietnamese for Beginners Book Details. Vietnamese for Beginners with CD Audio Jake Catlett, Huong Nguyen 9781887521567 Books Amazon.ca The Vietnamese language made easy. Vietnamese for Beginners is designed for either selfstudy or classroom use. Worlds most popular driver download site. DO NOT plug in the QX3 Installing the latest Intel Play QX3 drivers can fix fastest way to resolve driver related issues is to Download Driver Restore and follow the instructions above. Find great deals on eBay for intel play microscope and intel microscope. Shop with confidence. Intel Play Qx3 Computer Microscope Manual Digital Blue QX5 Digial Microscope microscopes for kids. I have downloaded and installed the Intel Play QX3 Monocular Microscope question Find best value and selection for your Intel Play QX3 MATTEL USB Computer Microscope search on eBay. Worlds leading marketplace. The math instruction solves equations that are entered as a formula on the screen. This is solved during the execution of the program. If floating point is used in any operation then the formula solves the equation using floating point.

The solution is stored in the data format selected for the to the PLC. 2. Name the four basic math functions performed by. PLCs. 3. What standard format is used for PLC math instructions 4. Would math instructions be classified as input or output instructions 5. With reference to the instruction of Figure 1124, what is the value of the number stored at source B if N73 contains a What standard format is used for PLC math instructions 4. what is the value of the number stored at the destination if N73 contains a value of 15 and N74 contains a value of 4. Would math instructions be classified as input or output instructions 5. what is the value of the number stored at the destination if N73 contains Math instructions is same as manipulation instructions so we allow the mathematical operation in PLC to the stored values in memory word or registers. PLC depends on what type of processor is used, various math instructions can be programmed. The bas view the full answer AnNajah National University. Faculty of Engineering. Electrical Engineering Department.

Programmable Logic Controller. Chapter 11. Math instruction The PLCs math functions capability allows it to perform arithmetic functions on values. Name the four basic math functions performed by PLCs. What standard format is used for PLC math instructions. Would math instructions be classified as input or output instructions. With reference to to instruction of Figure 1124, what is the value of the number stored at source B if N73 contains a value of 60 and 21 Sep 2012 These types of instructions are used by PLCs to gather data from various memory locations, to compare data, and to scale values. The standard format for math functions in many PLCs is is that the desired math operation is performed on a memory location, and not directly on a number. In other words, if Math Instructions. Lets now look at using some basic math functions on our data.

<https://labroclub.ru/blog/boss-gt-8-manual-deutsch>